



FOCUSED / COMPETENT / INSPIRED



FOCUSED / COMPETENT / INSPIRED

SHAHID BUILDERS

PAKISTAN

Head Office

Tel: +92 (42) 37172947, 37116255

Fax: +92 (42) 37172948

Email: info@shahidbuilders.com.pk

23-Ajmal Khan Street # 115, Lytton Road, Mozang, Lahore.

Branch Office

Tel: +92 (51) 2323835-36

Opposite G-13/2 Main Service Road, Street # 589,

Near Roots Millenium School, G-13/2, F-13, Islamabad.

MIDDLE EAST

Muscat Office

Tel: (968) 2281 6692

GSM: (968) 9460 6471

Email: info@shahidbuilders.com

Flat # 2, Building # 484, Plot # 419, Block # 246,
18th November Street, North Azaiba, Muscat

www.shahidbuilders.com.pk

facebook.com/shahidbuilders/



SHAHID BUILDERS

Engineers & Contractors

ABOUT US

The history of Shahid Builders stretches back to 1985. Over the years, the company has undertaken many challenging projects initiating itself from the construction of housing units to the construction of Buildings high end Hospitals, Highways, Clubs, Farm Lands & Parks. The company successfully competes the current challenges and also working for the future developments at national and international level through its most valuable manpower and modern constructional tools and equipment's.

Other than this, the company has gained significant expertise in Mechanical, Electrical and Plumbing works as well as in high end constructional machinery, Constructional Design and Planning Softwares. SBL also specializes in other fields such as finishing works, Water Supply and Sewerage works, Firefighting and HVAC works respectively.

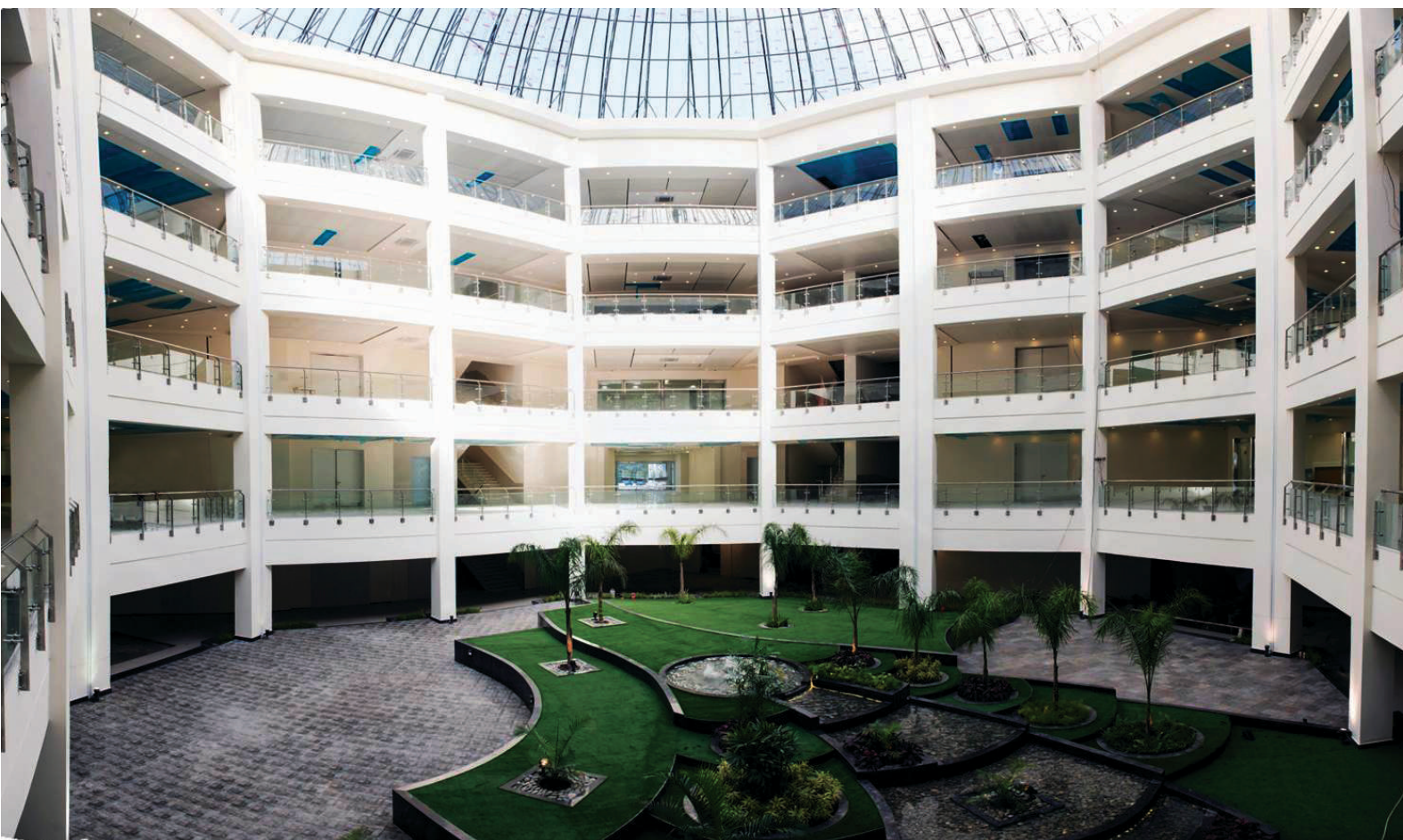

VISION & MISSION

Shahid Builders is considered to be one of the leading construction companies in Pakistan where it's main focus is on providing best quality finishes at any possible cost. Shahid builders considers their client the king and work in their best interest to get the best possible results.

The company works to procure projects at competitive prices, by providing safe working conditions, and through the delivery of quality work within reasonable time frame. Our project management and execution departments ideology is:

- To create detailed construction schedule to meet our clients project objective.
- To focus on quality and attention to detail.
- To communicate comprehensively with all our project's stakeholders.
- To focus on building team work.
- To complete and commission the project on time.

What we do

We provide a wide span of services to our clients, we do special projects for our clients and never hesitate to go extra mile because our primary objective is complete satisfaction of our clients and that to at any cost. To help our clients in the best way we provide the following services:

- Civil works
- Electrical works
- Plumbing works
- Mechanical works
- Farm Lands & Parks
- Road Construction
- HVAC
- Finishing works
- Bridges & Highways
- Management Services



WHAT WE HAVE

SBL provides state of the art construction, design and project equipment's which creates a competitive operational advantage and helps in the timely completion of projects. Our equipment's include bulldozers, excavators, CAT Loaders, batching plant, concrete pumps, transit mixers, trucks, loaders tower cranes and gantry cranes.



FINANCIAL

INFORMATION SUMMARY

Particulars	Details	
	Year	Pak Rupee
Average Annual Turnover of Last Three Financial Years	2016 - 2017	1,265,379,451
	2017 - 2018	1,520,358,159
	2018 - 2019	994,471,785
Total		3,780,209,395
Average Turnover		1,260,069,798

LIST OF PROJECTS UNDER PROCESS IN 2020-21

Sr#	Particulars of Project	Client Name / Nature of Works	Total Covered Area
1	Grand Entrance Building No. 3 DHA	DHA / Construction of Grand Entrance (B+G+6) Floor Smart City DHA Building No.3. Piling Civil, MEP, HVAC, Finishing & PEB Works. Complete in all respect.	18,588 Sqm
2	2- Bedroom Apartments (Block 11-20) Under Package-8	PHA / Construction of 2- Bed Apartments (Block 11-20) Under Package-8 (G+2) Incl. Civil, MEP, HVAC, Finishing & PEB Works. Complete in all respect.	13,941 Sqm
3	Family Wing 500 Bed Hospital	Cantt Board / Construction of Family Wing Hospital 500 Bed, (B+G+6). Exacavtion Works, Civil Works, MEP Works, HVAC and Finishing Works. Complete in all respect.	25,557 Sqm
4	OPD Ward Hospital at GINUM (Phase II)	WASO / Construction of OPD Ward Block at GINUM. Excavation Works, Civil Works, MEP Works and Finishing works. Complete in all respect	13,011 Sqm
5	Oncology Department, Military Hospital	MES / Construction of Oncology Department Combined Military Hospital (CMH). Excavation Works, Civil Works, MEP Works and Finishing works. Complete in all respect	9,294 Sqm
6	Admin Block, Al-Aleem Medical College	Kohinoor Textile Mills / Construction of Admin Block at Al Aleem Medical College. Civil Works, MEP Work and Finishing Works. Complete in all respect.	3,438 Sqm
7	36 x E Type Flats (T/S) at PMAD Colony.	M.E.S / Construction of 6 x E type Flats at PMAD Colony. Civil Works, MEP Works and Finishing Works. Complete in all respect.	5,833 Sqm

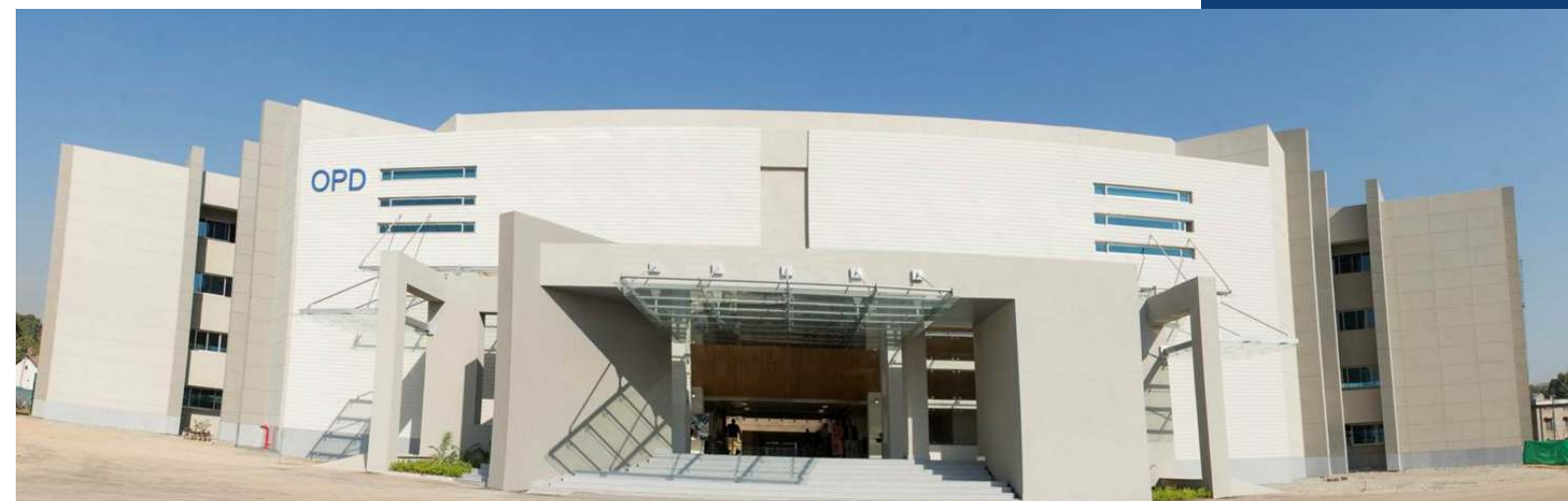

LIST OF PROJECTS COMPLETED IN 2019			
Sr#	Particulars of Project	Client Name / Nature of Works	Total Covered Area
1	Revamping of District Head Quarter & Tehsil Head Quarter Hospital Package 4	IDAP / Revamping and Construction of Hospital Building in all Tehsil and District Hospital. Water Supply and Sewerage Lines works, Civil Works, Finishing Works, External Electrification Works, Electrical Works, MEP Works and External Road Works. Complete in all respect.	40,985 Sqm
2	New Academic Block at Ghulam Ishaq Khan Institute of Engineering Sciences and Technology (GIKI)	GIKI / Construction of (B+G+6) Academic Block at GIKI one of Pakistan's leading academic institutes. With all allied activities with Civil works, MEP, Water and Sewerage Systems and with all Finishing Works.	23,234 Sqm

LIST OF PROJECTS COMPLETED IN 2018			
Sr#	Particulars of Project	Client Name / Nature of Works	Total Covered Area
1	NAB Headquarter Building	P.W.D / Construction of Multistory Building of National Accountability Bureau with allied Works (B+G+6) Piling Works, Civil Works, MEP Works & Finishing Works.	13,311 Sqm
2	Bank Of Khyber Building	Bank of Khyber / Construction of Multistory Building at Bank of Khyber with allied Works (B+G+6) such as Piling Works, and Civil Works.	22,770 Sqm
3	CASA REINA Luxury Apartment Building	CASA Ventures / Construction of Apartment Building with 2 Basements G+6. The building provides state of the Art facilities and all luxuries under one roof. Piling Works, Civil Works, MEP Works, HVAC, Fire Fighting work and High End Finishing works.	13,424 Sqm

LIST OF PROJECTS COMPLETED IN 2017			
Sr#	Particulars of Project	Client Name / Nature of Works	Total Covered Area
1	Package <ul style="list-style-type: none"> 48 x D Type Flats (G+3) Blocks 1,2,3,4,5 & 6. 2 x B-II Type Houses No 1,2,3 & 4. 	DGW & CE / Construction of 48 x D Type Flats, Blocks 1,2,3,4,5 & 6. Construction of 2xB-II Type Houses No 1,2,3&4. Civil Works, MEP Works, Fire Fighting and Finishing Works. Complete in all respect.	13,865 Sqm

LIST OF PROJECTS COMPLETED IN 2017			
Sr#	Particulars of Project	Client Name / Nature of Works	Total Covered Area
2	Polo Club & Park at Military Farm Lands	M.E.S / Construction of Polo Club & Park at Military Farm Lands. Infrastructure Works, Civil Works and MEP Works	4,183 Sqm

LIST OF PROJECTS COMPLETED IN 2016			
Sr#	Particulars of Project	Client Name / Nature of Works	Total Covered Area
1	Mental Health Department, Military Hospital	DGW & CE / Construction of Mental Health Department. Civil Works, MEP Works, Data & Voice Communication Works and Finishing Works.	10,362 Sqm
2	Admin Block House	DGW & CE / Construction of Admin Block House. Civil Works, MEP Works, IT Works, Firefighting works, Voice & Data communication works and Finishing Works.	4,027 Sqm
3	GC Mess 4 th Battalion PMA	DGW & CE / Construction of GC Mess 4th Battalion PMA. Civil Works, MEP Works, IT Works, Firefighting works, Voice & Data communication works and Finishing Works	11,524 Sqm
4	Cut Off Wall at ARDE-II Complex	C.W.O / Construction of Cut Off Wall at ARDE- II Complex. Concrete Works, Underground piping and pumping system & Deviation of Sub Soil Water.	1,450 Sqm
5	Military Corps BOQs Along with External Services	DGW & CE / Construction of Military Corps BOQs Along with External Services. Civil Works, MEP Works, IT Works, Fire Fighting Works, and Finishing Works	5,530 Sqm
6	Napier Lodges	DGW & CE / Construction of Napier Lodges. Civil Works, MEP Works, Finishing Works & External Works.	5,654 Sqm

LIST OF PROJECTS COMPLETED IN 2015			
Sr#	Particulars of Project	Client Name / Nature of Works	Total Covered Area
1	Officers Family Block	DGW & CE / Construction of Officer's Family Block. Civil Works, MEP Works, IT Works and finishing Works.	11,617 Sqm

LIST OF PROJECTS COMPLETED IN 2015

Sr#	Particulars of Project	Client Name / Nature of Works	Total Covered Area
2	32 x C Type Flats (G+3)	DGW & CE / Construction of 32 x C Type Flats. Civil Works, MEP Works, Fire-fighting Works and Finishing Works.	12,595 Sqm
3	Academic Block No 1 NUST- School of Health Sciences	NUST / Construction of Academic Block No 1 NUST. Civil Works, MEP Works and Finishing Works.	7,992 Sqm
4	48 x E Type Flats Blocks 5,6,7,8, 9 & 10	DGW & CE / Construction of 48 x E Type Flats (G+3) Blocks 5,6,7,8,9 & 10. Civil Works, MEP Works and Finishing Works.	11,821 Sqm
5	Guest House HQ 491 Engineers	W.O / Construction of Guest House. Civil Works, MEP Works, and Finishing Works.	1,487 Sqm
6	Pre School	Learning Alliance / Construction of Pre-School. Civil Works, MEP Works, and Finishing Works	3,253 Sqm

LIST OF PROJECTS COMPLETED IN 2014

Sr#	Particulars of Project	Client Name / Nature of Works	Total Covered Area
1	OPD Complex, Military Hospital	DGW & CE / Construction of OPD Complex. Civil Works, MEP Works, Fire Fighting Works, HVAC, Finishing Works and External Works	33,271 Sqm

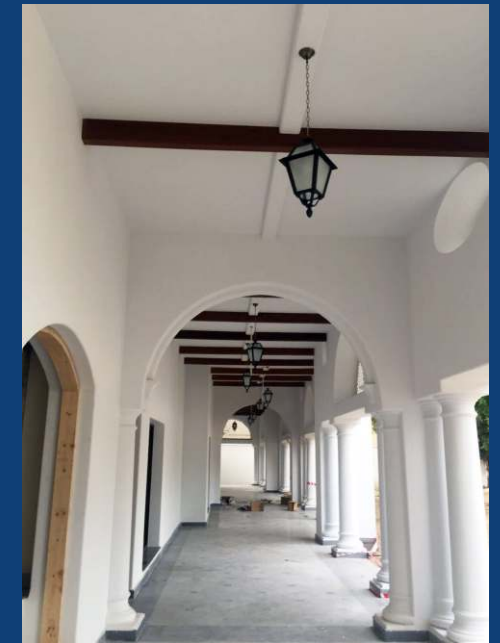

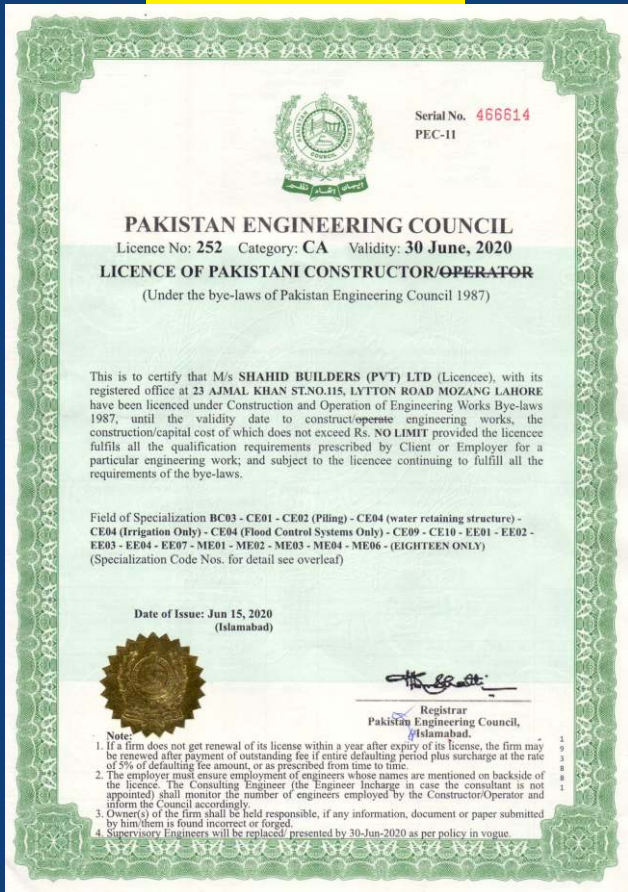
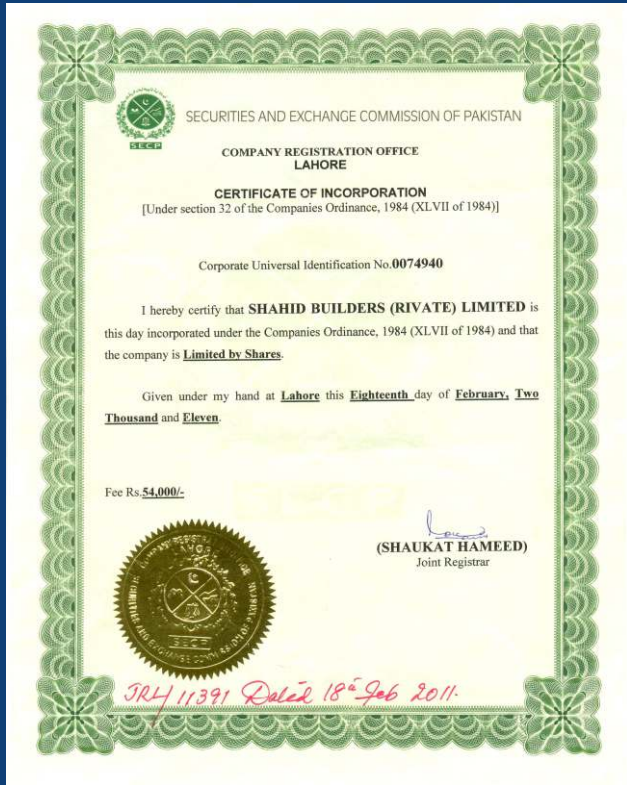



REGISTERED WITH



OUR CLIENTS

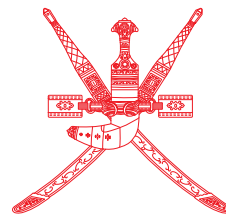
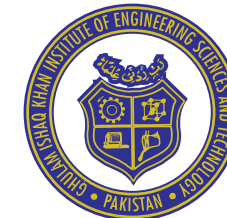

Sultanate of Oman
Muscat Municipality
DG of Muttrah

سلطنة عُمان
بلدية مسقط
المديرية العامة لبلدية مسقط بمطرح الكبرى

يجب مراجعة المديرية المختصة
للتصديق على نموذج اللائحة قبل تركيبها

ترخيص بلدي

رقم الترخيص : ب.م/١٩٤٨٦/٢٠١٩
الاسم التجاري : شاهد للبناء وشركاه ش م م
العنوان : * رقم الوحدة ٢ - مبنى رقم ٤٨٤ - شارع رقم ٢٤٦ شارع ١٨ نوفمبر - مجمع ٢٤٦ - الموقع : العذبية الشمالية
تاريخ الإصدار : ٢٠١٩/٠٧/١٦
النشاط : ١ مقاولات إنشاء الطرق (تشمل الشوارع والجسور والاتفاقات) (جميع الفئات)
٢ مقاولات البناء والتشييد (إنشاءات عامة للمباني السكنية والغير سكنية) (مقاولات البناء والتشييد)

رقم السجل : ١٣٤٥٣٩٥ - رمز الفرع : ٤٥٦١٣٠٥٨

التاريخ : ٢٠١٩/٠٧/١٦

يُعتمد : ٥٤٤

ملاحظات:
* يجب تجديد هذا الترخيص بعد انتهاء البدة المحددة أعلاه دون تأخير.
* الترخيص صالح للموقع المذكور أعلاه ولا يجوز استخدامه لأي موقع آخر.
* يوقع هذا الترخيص في مكان بارز بالمحل المرخص له.
* لا يسمح بتركيب لافتات تجارية على واجهها المباني السكنية والسكنية والتجارية بالطوابق العلوية (من الأول لأعلى).
* لا يسمح بتركيب اللائحة التجارية إلا بعد الحصول على موافقة البلدية على تركيبها في الموقع المحدد، وسيتم تحميل صاحبها إزالتها في حالة عدم مطابقتها مع الاشتراطات الفنية دون أية تعويضات.

REGISTERED WITH